

BULL20

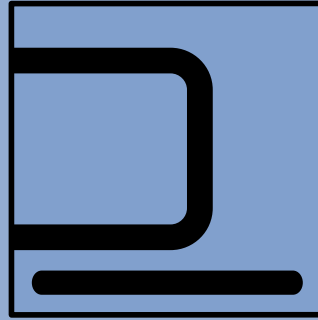

INDUSTRIAL USE

SINGLE-PHASE

- 230 Vac single-phase operator with built-in control panel and receiver
 - Self-ventilated version equipped with encoder
- Control unit with electronic braking
- Available in versions with magnetic limit switches (BULL20M.S)

THREE-PHASE

- Self-ventilated operator with external control unit
- Operator equipped with electric brake
 - Anti-crushing electronic brake
- Available in versions with magnetic limit switches (BULL20T.S)

Equipped with
foundation plate

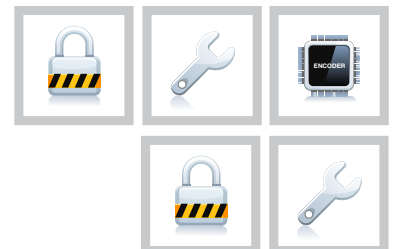

Functional design. Shape to convey all the strength and reliability of the motor



Sturdy key-operated personalized unlocking system



Self-ventilated versions

NOTES:

.....

.....

.....

.....

.....

.....

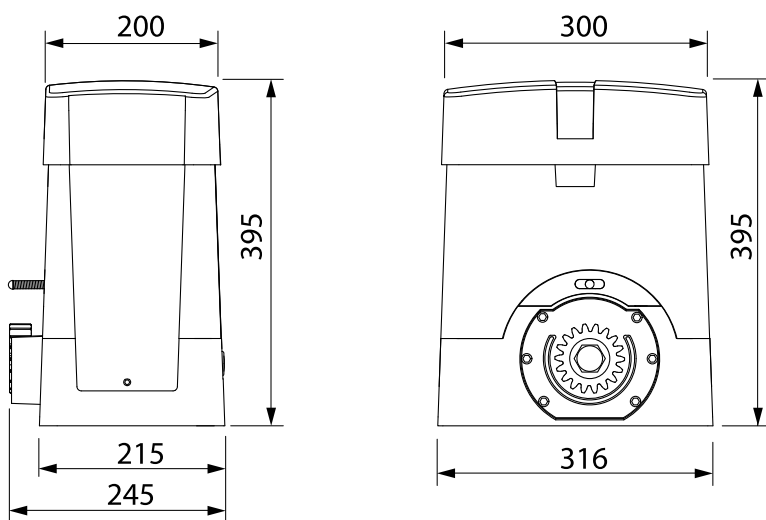
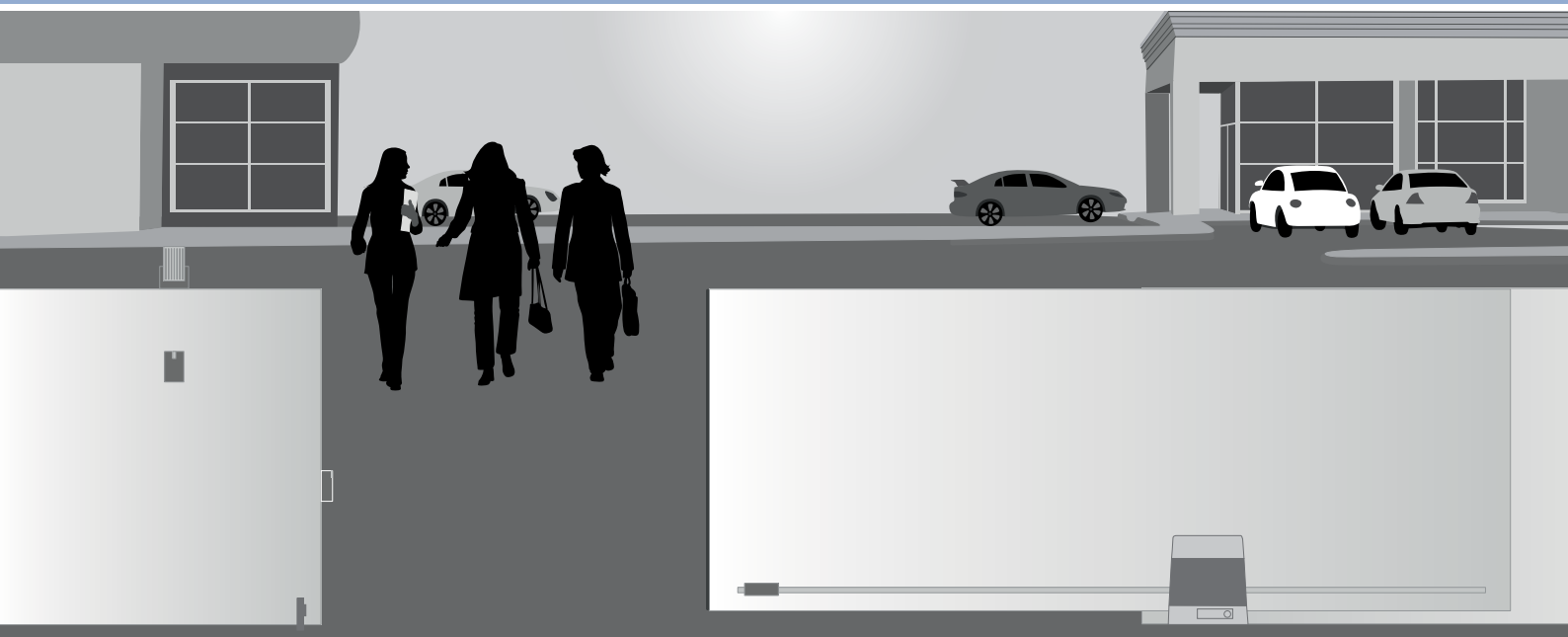

SETS AVAILABLE

- KBULL20M 20 Sets per pallet
- KBULL20M.S 20 Sets per pallet



TECHNICAL DATA	BULL20M	BULL20M.S	BULL20T	BULL20T.S
Power supply	230 Vac	230 Vac	400 Vac	400 Vac
Motor supply	230 Vac	230 Vac	400 Vac	400 Vac
Max. absorbed current	2,9 A	2,9 A	1,7 A	1,7 A
Thrust	1667 N	1667 N	2000 N	2000 N
Opening speed	10,5 m/min	10,5 m/min	10,5 m/min	10,5 m/min
Operation cycle	40%	40%	intensive use	intensive use
Protection level	IP 44	IP 44	IP 44	IP 44
Operating temp.	-20°C /+50°C	-20°C /+50°C	-20°C /+50°C	-20°C /+50°C
Max gate weight	2000 kg	2000 kg	2000 kg	2000 kg
Driving gear for rack	M4 Z18	M4 Z18	M4 Z18	M4 Z18
Magnetic limit switches	No	Yes	No	Yes
Weight	21,6 kg	21,6 kg	21,6 kg	21,6 kg
Items no. per pallet	20	20	20	20